

Erf 11117
(Stand 33)
Kabeljauws Beach

NOTES

THE DESIGN OF THIS DRAWING IS COPYRIGHT AND REMAINS THE PROPERTY OF THE ARCHITECT.
ALL RELEVANT DETAILS, LEVELS AND DIMENSIONS TO BE CHECKED ON SITE PRIOR TO COMMENCEMENT OF WORK.
THE ARCHITECT ACCEPTS NO RESPONSIBILITY FOR ERRORS RESULTING FROM MISINTERPRETATION OF THE DRAWINGS.
ALL DIMENSIONS ARE GIVEN IN MILLIMETERS. FOR INFORMATION ONLY UNLESS OTHERWISE STAMPED & SIGNED.
ALL STRUCTURAL WORK TO ENGINEERS SPECIFICATIONS.
ALL MATERIALS AND CONSTRUCTION METHODS MUST COMPLY WITH THE CURRENT NATIONAL BUILDING REGULATIONS INCLUDING ALL AMENDMENTS AS WELL AS THE BY-LAWS OF THE APPLICABLE LOCAL AUTHORITY.
ALL MATERIALS MUST BE FIXED AND FINISHED OFF IN ACCORDANCE WITH THE SPECIFICATIONS OF THE MANUFACTURER OF SUCH MATERIALS.
DRAWING ISSUED FOR INFORMATION ONLY UNLESS OTHERWISE STAMPED & SIGNED.
ALL ALUMINIUM WORK TO COMPLY WITH AAAMA SPECIFICATIONS AND STANDARDS.

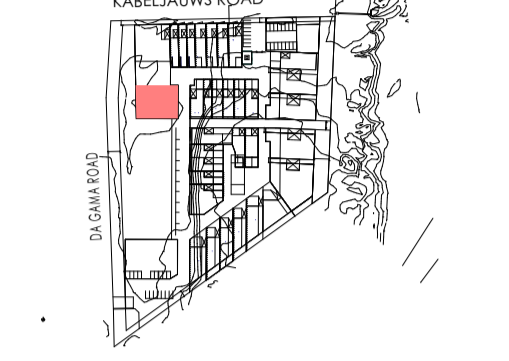

33
BLOCK A

Erf no. 11117
Stand no. 33
Area 1545m²

Parking (development parameters)
Total units = 16
Parking requirements = 1.25 per unit
Total parking required = 20

Parking Block A
8 apartments = 8 parking
(visitors on rest of stand 33)

STATUS

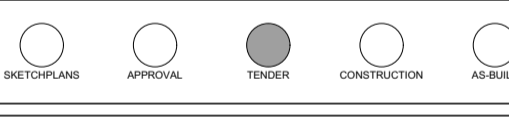

REVISIONS

REV	DATE	DESCRIPTION
01	28.08.19	Value engineering after first tenders received



KABELJAUWS BEACH
— est. 2014 —

PROJECT
**APARTMENTS - BLOCK A
STAND 33
(ERF 11117)**

DRAWING
**TENDER DRAWINGS
GROUND FLOOR**

SCALE: 1:50 @ A1 DATE: 2019.08.28
1:100 @ A3

DRAWN: LW/WHM CHECKED: SM/EM

DRAWING NO: D205 0101 0101 02 ERF33 03
3001

BLOCK A | GROUND FLOOR PLAN

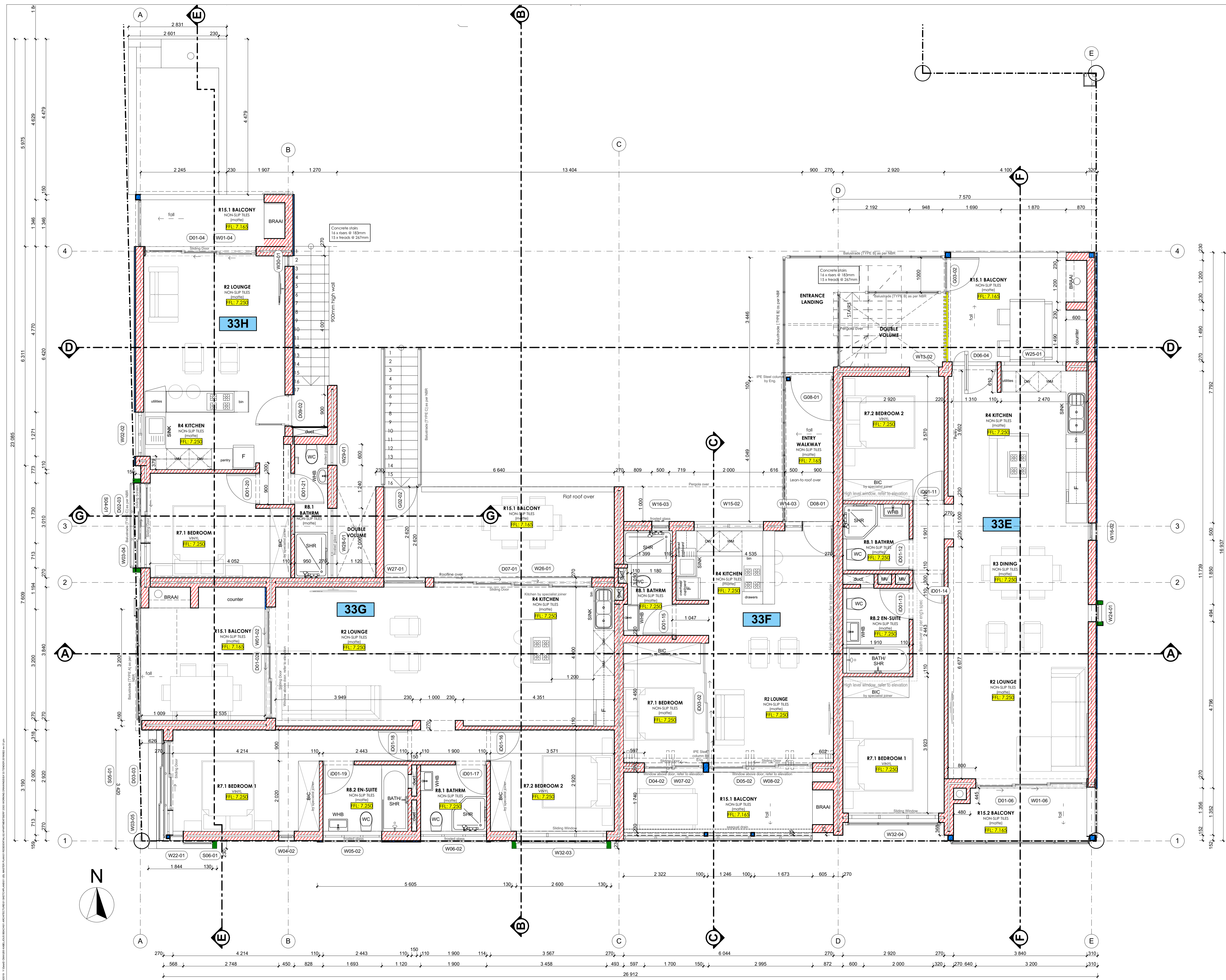

NOTES

THE DESIGN OF THIS DRAWING IS COPYRIGHT AND REMAINS THE PROPERTY OF THE ARCHITECT.
 ALL RELEVANT DETAILS, LEVELS AND DIMENSIONS TO BE CHECKED ON SITE PRIOR TO COMMENCEMENT OF WORK.
 THE ARCHITECT ACCEPTS NO RESPONSIBILITY FOR ERRORS RESULTING FROM MISINTERPRETATION OF THE DRAWINGS.
 ALL DIMENSIONS ARE GIVEN IN MILLIMETERS FOR INFORMATION ONLY UNLESS OTHERWISE STAMPED & SIGNED.
 ALL STRUCTURAL WORK TO ENGINEERS SPECIFICATIONS.
 ALL MATERIALS AND CONSTRUCTION METHODS MUST COMPLY WITH THE CURRENT NATIONAL BUILDING REGULATIONS INCLUDING ALL AMENDMENTS AS WELL AS THE BY-LAWS OF THE APPLICABLE LOCAL AUTHORITY.
 ALL MATERIALS MUST BE FIXED AND FINISHED OFF IN ACCORDANCE WITH THE SPECIFICATIONS OF THE MANUFACTURER OF SUCH MATERIALS.
 DRAWING ISSUED FOR INFORMATION ONLY UNLESS OTHERWISE STAMPED & SIGNED.
 ALL ALUMINIUM WORK TO COMPLY WITH AAASMA SPECIFICATIONS AND STANDARDS.



33
BLOCK A

Erf no. 11117
 Stand no. 33
 Area 1545m²

Parking (development parameters)
 Total units = 16
 Parking requirements = 1.25 per unit
 Total parking required = 20

Parking Block A
 8 apartments = 8 parking
 (visitors on rest of stand 33)

STATUS

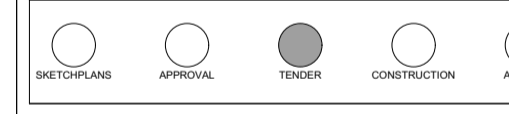

REVISIONS

REV	DATE	DESCRIPTION
01	28.08.19	Value engineering after first tenders received



KABELJAUWS BEACH
 — est. 2014 —

PROJECT
**APARTMENTS - BLOCK A
 STAND 33
 (ERF 11117)**

DRAWING
**TENDER DRAWINGS
 FIRST FLOOR**

SCALE 1:50 @ A1 DATE 2019.08.28
 1:100 @ A3

DRAWN LWW/WHM CHECKED SM/EM

DRAWING NO. D205 0101 0101 02 ERF33 03
 3002

BLOCK A | FIRST FLOOR PLAN

DRAWING: 1:500 SCALE (SEE DRAWING 01) ARCHITECT: CMAI CONSULTANTS PROJECT: APARTMENTS - BLOCK A STAND 33 (ERF 11117) DATE: 2019.08.28